

Rubber Flex Curb Specifications

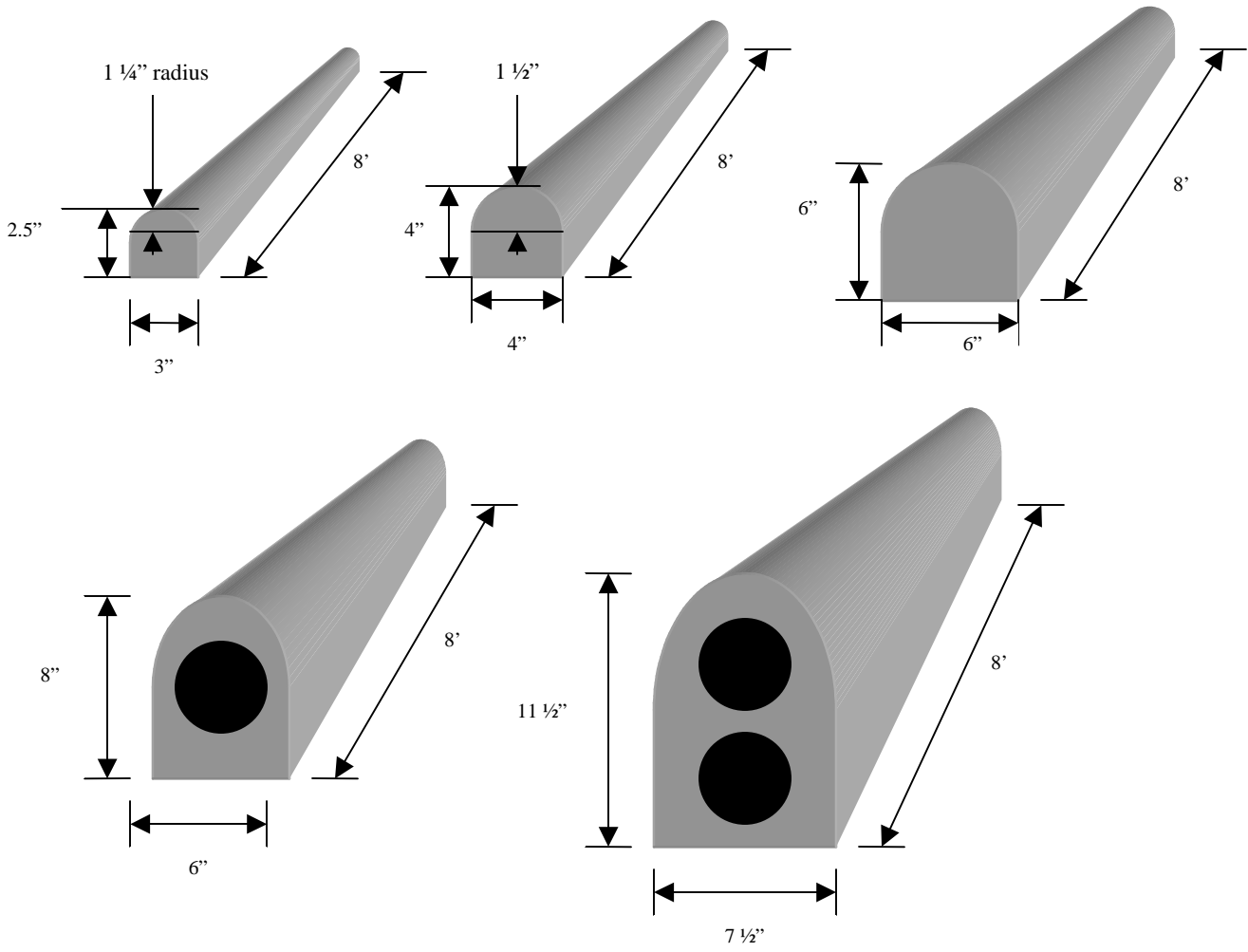

Sizes/Weight (Actual Sizes are noted in diagrams)	2.5"x3"x8': 22 lbs 4"x4"x8': 33 lbs 6"x6"x8': 66 lbs 6"x8"x8': 65 lbs 8"x12"x8': 112 lbs
Colors	Red, Green, Brown, and Black
Fall Height Attenuation	6"x8"x8' G-Max ≤200: 11' HIC ≤ 1,000: 12'
Corrugated/Perforated Pipe	1 ea 4" Pipe located in center of 6"x8"x8' and 2 ea 4" Pipe located in center of 8"x12"x8' Curb to collect and channel water, reduce weight, and allows for easier handling.
Water Drain Ports	3/4" x 3/4" Channels running the width of the bottom of Curb for better drainage
Rebar Anchor Size (If Applicable)	2.5" & 4" Curb: 3/8"x18" 6", 8", & 12" Curb: 1/2"x24"

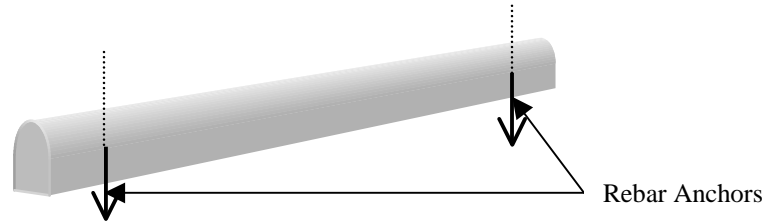

Installation Instructions (When Using Rebar Anchors)

1. Drill a 1/4" hole (for 3" and 4" curbs) or a 3/8" hole (for 6", 8" and 12" curbs) 8" from each end of the curb.
2. Insert 3/8" rebar anchors (for 3" and 4" curbs) or 1/2" rebar anchors (for 6", 8", and 12" curbs) into the holes and drive into the ground. Recess the anchors to approximately half the thickness of the curb.
3. A rebar anchor should also be placed in the center of the curb.

*Do not place anchor in severe bend of curb!

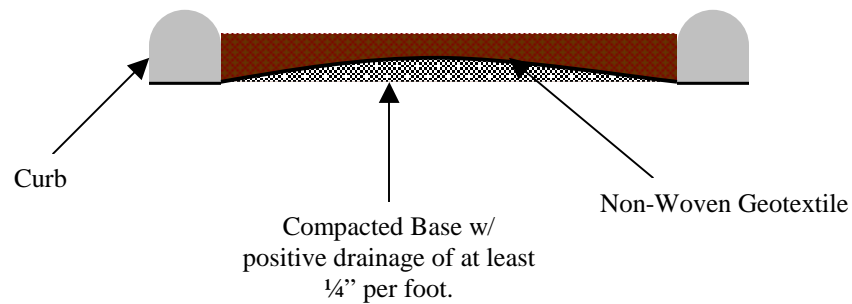

Installation Instructions (When Using Adhesive)

1. Install Non-Woven Geotextile Membrane over compacted base.
2. Glue Rubber Flex Curb to textile.
3. Glue Curbs end to end.